



**dukes, inc.**  
9060 winnetka avenue  
northridge, california 91324

**MANDATORY SERVICE BULLETIN**

NO. 0002/PAGE 1

6-15-93

**SUBJECT: DUKES INC. ELECTRIC FUEL BOOST PUMPS**

**PURPOSE:** THIS BULLETIN IS NECESSITATED BY THE FACT THAT SOME OF THE CARBON VANES IN THE OLDER PUMPS HAVE SHATTERED DUE TO THE INGESTION OF CONTAMINATES INTO THE PUMP. IN SOME CASES THESE PARTICLES HAVE FOUND THEIR WAY TO THE MAIN ENGINE FUEL PUMP AND CAUSED THE REED TYPE VALVES TO MALFUNCTION, RESULTING IN REDUCTION OR LOSS OF ENGINE POWER. COMPLIANCE IS ACCOMPLISHED BY THE INSTALLATION OF DUKES ROTOR KIT 2140-220. THIS KIT WILL REPLACE CARBON VANES WITH VANES MADE OF NYLATRON, WHICH IS EXTREMELY RESISTANT TO SHATTERING (SEE ITEM NO. 6.)

**NOTE:** ANY PUMP EITHER NEW OR OVERHAULED BY DUKES INC. AFTER 1/1/88 ALREADY CONTAINS NYLATRON VANES. THESE PUMPS CAN BE IDENTIFIED BY EITHER A YELLOW DECAL ON THE BASE OF THE PUMP OR BY THE LETTERS "NV" FOLLOWING THE PART NUMBER. PUMPS IDENTIFIED AS CONTAINING NYLATRON WILL NOT REQUIRE SERVICE UNTIL THE TEN YEAR TBO HAS BEEN REACHED.

**COMPLIANCE:** COMPLIANCE MUST BE ACCOMPLISHED BY EITHER REPLACEMENT WITH A NEW PUMP, OR OVERHAUL OF THE EXISTING PUMP BY DUKES INC. OR AN FAA CERTIFIED REPAIR STATION (REQUIRED COMPONENT PARTS MUST BE PURCHASED FROM BEECHCRAFT OR THEIR AUTHORIZED DEALERS.) COMPLIANCE IS MANDATORY WITHIN THE NEXT 100 HOURS OR NOT LATER THAN 6/1/94.

**RESPONSIBILITY:** WILL BE THE OWNER/OPERATOR.

**EFFECTIVITY:** SEE ATTACHED LIST FOR AFFECTED DUKES PART NUMBERS.



**dukes, inc.**

9060 winnetka avenue  
northridge, california 91324

**MANDATORY SERVICE BULLETIN**

NO. 0002/PAGE 2

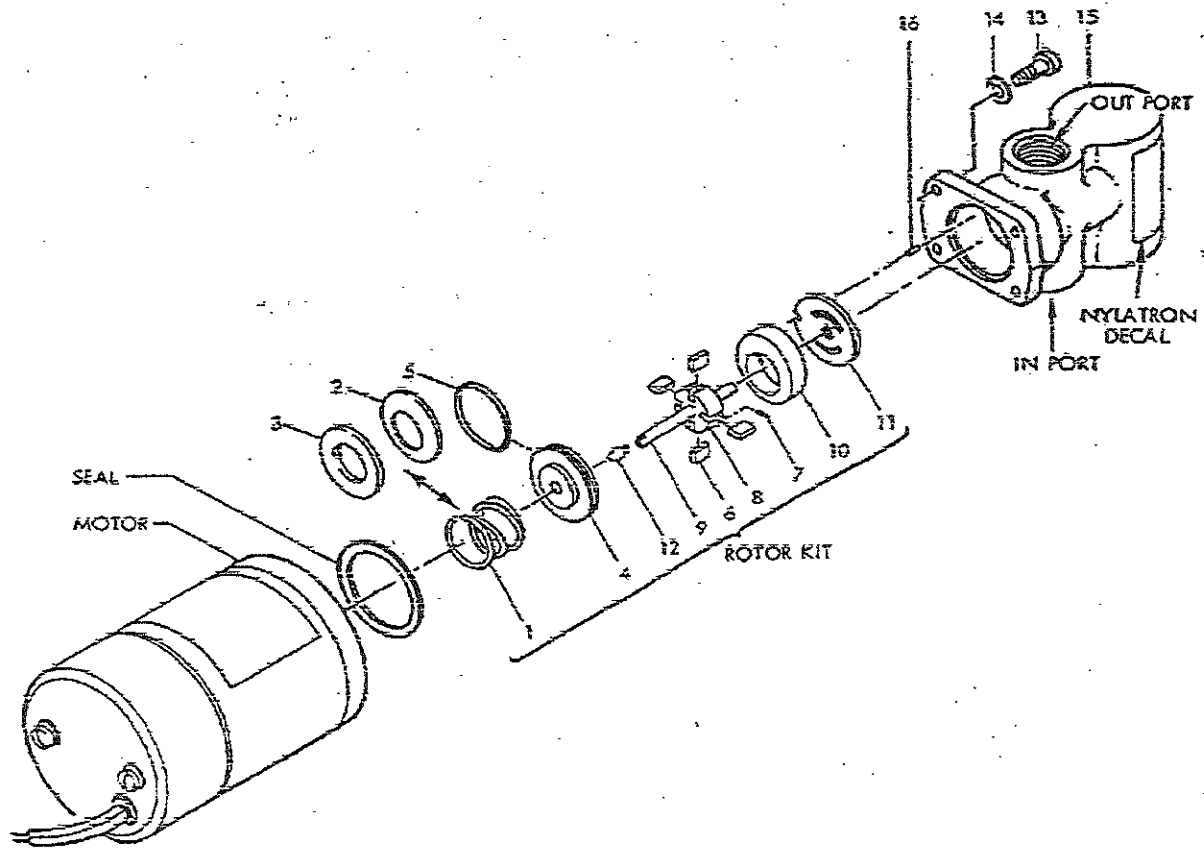

**DUKES 4140 SERIES  
ELECTRIC FUEL BOOST PUMP**

**dukes, inc.**9060 winnetka avenue  
northridge, california 91324**MANDATORY SERVICE BULLETIN****B.E.E.C.H.C.R.A.F.T**

NO.0002/PAGE 3

4140-00	Prior to S/N:	2835
4140-00-1	Prior to S/N:	3681
4140-00-7	Prior to S/N:	2141
4140-00-11	Prior to S/N:	1789
4140-00-39	Prior to S/N:	6264
4140-00-103	Prior to S/N:	<del>0444</del>
4150-00-1	Prior to S/N:	ALL
4258-00	Prior to S/N:	0378
4404-00-1	Prior to S/N:	9864
4404-00-7	Prior to S/N:	0924
4613-00-1	Prior to S/N:	0820
4613-00-3	Prior to S/N:	0355
1132-00-1	Prior to S/N:	0167
1171-00-1	Prior to S/N:	0807
1296-00-1	Prior to S/N:	3535
1420-00-1	Prior to S/N:	0251

# Beechcraft.

# MANDATORY SERVICE BULLETIN

33, 35, 36, 55, 58, 85

No. 2526  
ATA Code 28-20

**SUBJECT:** FUEL - DUKES INC. ELECTRIC FUEL BOOST PUMP INSPECTION AND OVERHAUL/REPLACEMENT.

**REASON:** This Service Bulletin is being issued to announce Dukes Service Bulletin No. 0002, which calls for the overhaul or replacement of carbon vane equipped electric fuel boost pumps. Carbon vanes on older Dukes fuel pumps have been known to shatter. Fragments of the shattered carbon vane can interfere with downstream powerplant components, resulting in reduced or lost engine power. Dukes is replacing the carbon vanes with vanes of an improved material, Nylatron.

**EFFECTIVITY:** COMMERCIAL AIRPLANES

BEECHCRAFT Debonair/Bonanza 35-33, 35-A33, 35-B33, 35-C33, 35-C33A, E33, F33, and G33, serials CD-1 through QD-1304;

Bonanza 35-C33A, E33A and F33A, serials CE-1 through CE-1237;

E33C and F33C, serials CJ-1 through CJ-179;

Non turbo-charged Bonanza N35, P35, S35, V35, V35A and V35B, serials D-8582 through D-8035, D-8037 through D-8047, D-8049 through D-8056, D-8058 through D-8063, D-8065 through D-8071, D-8073, D-8074, D-8076 through D-8089, D-8091 through D-8126, D-8128 through D-8132, D-8134 through D-8139, D-8041 through D-8145, D-8147 through D-8152, D-8154 through D-8175, D-8177 through D-8180, D-8182, D-8183, D-8185 through D-8187, D-8189, D-8191 through D-8193, D-8195 through D-8198, D-8200 through D-8204, D-8208 through D-8209, D-8211 through D-8215, D-8218 through D-8228, D-8230 through D-8236, D-8235 through D-8239, D-8240, D-8241, D-8243, D-8244, D-8246 through D-8248, D-8250 through D-8254, D-8256 through D-8260, D-8262 through D-8266, D-8268 through D-8273, D-8275 through D-8278, D-8280 through D-8285, D-8287 through D-8293, D-8295 through D-8299, D-8301 through D-8306, D-8308 through D-8315, D-8317 through D-8322, D-8324 through D-8327, D-8329 through D-8335, D-8337 through D-8345, D-8347 through D-8352, D-8354 through D-8358, D-8360 through D-8365, D-8367 through D-8372, D-8374 through D-8378, D-8380 through D-8384, D-8386 through D-8392, D-8394 through D-8399, D-8401 through D-8406, D-8408 through D-8418, D-8420 through D-8426, D-8428 through D-8431, D-8433 through D-8437, D-8439 through D-8446, D-8448 through D-8455, D-8457 through D-8464, D-8466 through D-8469, D-8471 through D-8474, D-8476 through D-8480, D-8482 through D-8484, D-8486 through D-8489, D-8491 through D-8485, D-8497 through D-8499, D-8501 through D-8504, D-8506 through D-8508, D-8510 through D-8513, D-8515 through D-8517, D-8519 through D-8525, D-8527 through D-8529, D-8531, D-8532, D-8534 through D-8539, D-8541 through D-8551, D-8553 through D-8559, D-8561 through D-8566, D-8568 through D-8576, D-8578 through D-8585, D-8597 through D-8605, D-8607 through D-8614, D-8616 through D-8624, D-8626, D-8627, D-8629 through D-8637, D-8639 through D-8651,

No BECP M

Issued: December, 1993

1 of 3

Beech Aircraft Corporation issues Service Information for the benefit of owners and fixed based operators in the form of two classes of Service Bulletins. The first class, Mandatory Service Bulletins (MSB) contain changes, inspections and modifications that could affect safety or crashworthiness. Beech considers compliance with these Service Bulletins to be mandatory. Beech also issues a Service Bulletin having no letter which is designated as either recommended or optional in the Compliance Section within the Bulletin. In the case of recommended Service Bulletins, Beech feels the changes, modifications, improvements or inspections will benefit the owner and although highly recommended, they are not considered mandatory at the time of issuance. In the case of optional Service Bulletins, compliance with the changes, modifications, improvements or inspections is at the owner/operator's discretion. Both classes are mailed to:

(a) BEECHCRAFT Authorized Outlets.

(b) Owners of records on the FAA Aircraft Registration Branch List and the BEECHCRAFT International Owner Notification Service List.

(c) Those having a publications subscription.

Information on Owner Notification Service or subscriptions can be obtained through any BEECHCRAFT Authorized Outlet. As Mandatory Service Bulletins and Service Bulletins are issued, temporary notification in the Service Bulletin Master Index should be made until the index is revised. Warranty will be allowed only when specifically defined in the Service Bulletin and in accordance with the Beech Aircraft Corporation Warranty Policy.

Unless otherwise designated, Beech Aircraft Corporation Mandatory Service Bulletins, Service Bulletins and BEECHCRAFT Kits are approved for installation on BEECHCRAFT airplanes in original or BEECHCRAFT modified configurations only. BEECHCRAFT Mandatory Service Bulletins, Service Bulletins and Kits may not be compatible with airplanes modified by STC installations or modifications other than BEECHCRAFT Approved data.

88-8307/10783



Member of GAMA  
General Aviation  
Manufacturers Association

**Beechcraft**  
A Raytheon Company

M  
A  
N  
D  
A  
T  
O  
R  
Y

**Service Bulletin No. 2526**

D-8653 through D-8661, D-8663 through D-8672, D-8674 through D-8680, D-8682 through D-8693, D-8695 through D-8704, D-8706 through D-8714, D-8716 through D-8729, D-8731 through D-8743, D-8745 through D-8762, D-8764 through D-8776, D-8778 through D-8789, D-8791 through D-8809, D-8811 through D-8822, D-8824 through D-8828, D-8830 through D-8834, D-8836 through D-8841, D-8843 through D-8849, D-8850 through D-8854, D-8856 through D-8860, D-8862 through D-8867, D-8869 through D-8874, D-8876 through D-8886, D-8888 through D-8900, D-8902 through D-8910, D-8912 through D-8920, D-8922 through D-8929, D-8931 through D-8939, D-8941 through D-8950, D-8952 through D-8960, D-8962 through D-8972, D-8974 through D-8981, D-8983 through D-8991, D-8993 through D-9000, D-9002 through D-9007, D-9009 through D-9018, D-9020 through D-9026, D-9028 through D-9036, D-9040 through D-9047, D-9049 through D-9054, D-9056 through D-9062, D-9064 through D-9069, D-9071 through D-9077, D-9079 through D-9087, D-9089 through D-9106, D-9108 through D-9130, D-9132 through D-9153, D-9155 through D-9179, D-9181 through D-10403.

Bonanza 35 and A35, serials E-1 through E-2419;

Baron 95-55, 95-A55, and 95-B55, serials TC-1 through TC-349, TC-351 through TC-1392, TC-1397 through TC-1401, TC-1403 through TC-2456;

95-C55, D55 and E55, serials TC-350, TE-1 through TE-1201;

Baron 58 and 58A, serials TH-1 through TH-1535;

Travel Air B95A, D95A and E95, serials TD-453 through TD-721.

**MILITARY AIRPLANES**

Baron 95B55B (T-42A), serials TF-1 through TF-70.

**COMPLIANCE:**

Beech Aircraft Corporation considers this to be a mandatory modification and it must be accomplished as soon as possible after receipt of this Service Bulletin within the next 100 flight hours, but no later than June 1, 1994.

An Airworthiness Directive has been requested on the matter covered by this Service Bulletin.

**APPROVAL:**

Engineering data contained in this Service Bulletin is FAA approved.

**MANPOWER:**

The following information is for planning purposes only:

Estimated man-hours: 5 hours per fuel pump.

Suggested number of men: 1 man.

The above is an estimate based on experienced, properly equipped personnel complying with this Service Bulletin. Occasionally, after work has started, conditions may be found which could result in additional man-hours.

**MATERIAL:**

The following parts required for this modification may be ordered through a BEECHCRAFT Authorized Outlet:

PART NUMBER	DESCRIPTION	QUANTITY PER AIRPLANE
2140-220	Dukes Rotor Kit	1

REFER TO DUKES SERVICE BULLETIN NO. 0002 FOR APPLICABLE FUEL PUMP PART NUMBERS.

**SPARES AFFECTED:**

None.

**WARRANTY CREDIT:**

None.

**SPECIAL TOOLS:**

None.

**WEIGHT AND BALANCE:**

None.

**REFERENCES:**

Dukes, Inc. Mandatory Service Bulletin No. 0002, dated 6-15-93.

**Service Bulletin No. 2526****PUBLICATIONS****AFFECTED:**

It is recommended that a note to "See Service Bulletin No. 2526" be made in the appropriate chapter/section of the applicable Parts Catalog.

**ACCOMPLISHMENT****INSTRUCTIONS:**

This Service Bulletin shall be accomplished as follows:

1. Gain access to the engine fuel boost pump part and serial numbers, and refer to Dukes Service Bulletin No. 0002 (attached).

a. If a pump has a yellow decal on the base, or the letters "NV" following the part number, no further action is necessary.

b. If a pump does not have a yellow decal on the base, or the letters "NV" following the part number, it

must be overhauled or replaced, as indicated in the Dukes Service Bulletin.

**NOTE**

Beech Aircraft Corporation assumes no responsibility for supplying future vendor bulletins or revisions to this vendor service bulletin.

**RECORD COMPLIANCE:** Upon completion of this Service Bulletin, make an appropriate maintenance record entry.

**NOTE**

If you are no longer in possession of this airplane, please forward this information to the present owner.

33, 35, 36, 55, 58, 95

No. 2526  
ATA Code 28-20

**SUBJECT:** FUEL - DUKES INC. ELECTRIC FUEL BOOST PUMP INSPECTION AND OVERHAUL/  
REPLACEMENT.

**REASON:** This Service Bulletin is being issued to announce Dukes Service Bulletin No. 0002, which calls for the overhaul or replacement of carbon vane equipped electric fuel boost pumps. Carbon vanes on older Dukes fuel pumps have been known to shatter. Fragments of the shattered carbon vane can interfere with downstream powerplant components, resulting in reduced or lost engine power. Dukes is replacing the carbon vanes with vanes of an improved material, Nylatron.

**EFFECTIVITY:** COMMERCIAL AIRPLANES

BEECHCRAFT Debonair/Bonanza 35-33, 35-A33, 35-B33, 35-C33, 35-C33A, E33, F33, and G33, serials CD-1 through CD-1304;

Bonanza 35-C33A, E33A and F33A, serials CE-1 through CE-1237;

E33C and F33C, serials CJ-1 through CJ-179;

Non turbo-charged Bonanza N35, P35, S35, V35, V35A and V35B, serials D-6562 through D-8035, D-8037 through D-8047, D-8049 through D-8056, D-8058 through D-8063, D-8065 through D-8071, D-8073, D-8074, D-8076 through D-8089, D-8091 through D-8126, D-8128 through D-8132, D-8134 through D-8139, D-8041 through D-8145, D-8147 through D-8152, D-8154 through D-8175, D-8177 through D-8180, D-8182, D-8183, D-8185 through D-8187, D-8189, D-8191 through D-8193, D-8195 through D-8198, D-8200 through D-8204, D-8206 through D-8209, D-8211 through D-8216, D-8218 through D-8228, D-8230 through D-8233, D-8235 through D-8238, D-8240, D-8241, D-8243, D-8244, D-8246 through D-8248, D-8250 through D-8254, D-8256 through D-8260, D-8262 through D-8266, D-8268 through D-8273, D-8275 through D-8278, D-8280 through D-8285, D-8287 through D-8293, D-8295 through D-8299, D-8301 through D-8306, D-8308 through D-8315, D-8317 through D-8322, D-8324 through D-8327, D-8329 through D-8335, D-8337 through D-8345, D-8347 through D-8352, D-8354 through D-8358, D-8360 through D-8365, D-8367 through D-8372, D-8374 through D-8378, D-8380 through D-8384, D-8386 through D-8392, D-8394 through D-8399, D-8401 through D-8406, D-8408 through D-8418, D-8420 through D-8426, D-8428 through D-8431, D-8433 through D-8437, D-8439 through D-8446, D-8448 through D-8455, D-8457 through D-8464, D-8466 through D-8469, D-8471 through D-8474, D-8476 through D-8480, D-8482 through D-8484, D-8486 through D-8489, D-8491 through D-8495, D-8497 through D-8499, D-8501 through D-8504, D-8506 through D-8508, D-8510 through D-8513, D-8515 through D-8517, D-8519 through D-8525, D-8527 through D-8529, D-8531, D-8532, D-8534 through D-8539, D-8541 through D-8551, D-8553 through D-8559, D-8561 through D-8566, D-8568 through D-8576, D-8578 through D-8595, D-8597 through D-8605, D-8607 through D-8614, D-8616 through D-8624, D-8626, D-8627, D-8629 through D-8637, D-8639 through D-8651,

No BECP M

Issued: December, 1993

1 of 3

Beech Aircraft Corporation issues Service Information for the benefit of owners and fixed based operators in the form of two classes of Service Bulletins. The first class, Mandatory Service Bulletins (Red Border) includes changes, inspections and modifications that could affect safety or crashworthiness. Beech considers compliance with these Service Bulletins to be mandatory. Beech also issues a Service Bulletin having no border which is designated as either recommended or optional in the Compliance Section within the Bulletin. In the case of recommended Service Bulletins, Beech feels the changes, modifications, improvements or inspections will benefit the owner and although highly recommended, they are not considered mandatory at the time of issuance. In the case of optional Service Bulletins, compliance with the changes, modifications, improvements or inspections is at the owner/operator's discretion. Both classes are mailed to:

(a) BEECHCRAFT Authorized Outlets.

(b) Owners of record on the FAA Aircraft Registration Branch List and the BEECHCRAFT International Owner Notification Service List.

(c) Those having a publications subscription.

Information on Owner Notification Service or subscriptions can be obtained through any BEECHCRAFT Authorized Outlet. As Mandatory Service Bulletins and Service Bulletins are issued, temporary notification in the Service Bulletin Master Index should be made until the index is revised. Warranty will be allowed only when specifically defined in the Service Bulletin and in accordance with the Beech Aircraft Corporation Warranty Policy.

Unless otherwise designated, Beech Aircraft Corporation Mandatory Service Bulletins, Service Bulletins and BEECHCRAFT Kits are approved for installation on BEECHCRAFT airplanes in original or BEECHCRAFT modified configurations only. BEECHCRAFT Mandatory Service Bulletins, Service Bulletins and Kits may not be compatible with airplanes modified by STC installations or modifications other than BEECHCRAFT Approved kits.

98-35071/0793



Member of GAMA  
General Aviation

Beechcraft®  
A Raytheon Company

M  
A  
N  
D  
A  
T  
O  
R  
Y

**Service Bulletin No. 2526**

D-8653 through D-8661, D-8663 through D-8672, D-8674 through D-8680, D-8682 through D-8693, D-8695 through D-8704, D-8706 through D-8714, D-8716 through D-8729, D-8731 through D-8743, D-8745 through D-8762, D-8764 through D-8776, D-8778 through D-8789, D-8791 through D-8809, D-8811 through D-8822, D-8824 through D-8828, D-8830 through D-8834, D-8836 through D-8841, D-8843 through D-8848, D-8850 through D-8854, D-8856 through D-8860, D-8862 through D-8867, D-8869 through D-8874, D-8876 through D-8886, D-8888 through D-8900, D-8902 through D-8910, D-8912 through D-8920, D-8922 through D-8929, D-8931 through D-8939, D-8941 through D-8950, D-8952 through D-8960, D-8962 through D-8972, D-8974 through D-8981, D-8983 through D-8991, D-8993 through D-9000, D-9002 through D-9007, D-9009 through D-9018, D-9020 through D-9026, D-9028 through D-9038, D-9040 through D-9047, D-9049 through D-9054, D-9056 through D-9062, D-9064 through D-9069, D-9071 through D-9077, D-9079 through D-9087, D-9089 through D-9106, D-9108 through D-9130, D-9132 through D-9153, D-9155 through D-9179, D-9181 through D-10403.

Bonanza 36 and A36, serials E-1 through E-2419;

Baron 95-55, 95-A55, and 95-B55, serials TC-1 through TC-349, TC-351 through TC-1392, TC-1397 through TC-1401, TC-1403 through TC-2456;

95-C55, D55 and E55, serials TC-350, TE-1 through TE-1201;

Baron 58 and 58A, serials TH-1 through TH-1535;

Travel Air B95A, D95A and E95, serials TD-453 through TD-721.

**MILITARY AIRPLANES**

Baron 95B55B (T-42A), serials TF-1 through TF-70.

**COMPLIANCE:**

Beech Aircraft Corporation considers this to be a mandatory modification and it must be accomplished as soon as possible after receipt of this Service Bulletin within the next 100 flight hours, but no later than June 1, 1994.

An Airworthiness Directive has been requested on the matter covered by this Service Bulletin.

**APPROVAL:**

Engineering data contained in this Service Bulletin is FAA approved.

**MANPOWER:**

The following information is for planning purposes only:

Estimated man-hours: 5 hours per fuel pump.

Suggested number of men: 1 man.

The above is an estimate based on experienced, properly equipped personnel complying with this Service Bulletin. Occasionally, after work has started, conditions may be found which could result in additional man-hours.

**MATERIAL:**

The following parts required for this modification may be ordered through a BEECHCRAFT Authorized Outlet:

PART NUMBER	DESCRIPTION	QUANTITY PER AIRPLANE
2140-220	Dukes Rotor Kit	1

REFER TO DUKES SERVICE BULLETIN NO. 0002 FOR APPLICABLE FUEL PUMP PART NUMBERS.

**SPARES AFFECTED:** None.

**WARRANTY CREDIT:** None.

**SPECIAL TOOLS:** None.

**WEIGHT AND BALANCE:** None.

**REFERENCES:** Dukes, Inc. Mandatory Service Bulletin No. 0002, dated 6-15-93.

**PUBLICATIONS**

**AFFECTED:**

It is recommended that a note to "See Service Bulletin No. 2526" be made in the appropriate chapter/section of the applicable Parts Catalog.

**ACCOMPLISHMENT**

**INSTRUCTIONS:**

This Service Bulletin shall be accomplished as follows:

1. Gain access to the engine fuel boost pump part and serial numbers, and refer to Dukes Service Bulletin No. 0002 (attached).

a. If a pump has a yellow decal on the base, or the letters "NV" following the part number, no further action is necessary.

b. If a pump does not have a yellow decal on the base, or the letters "NV" following the part number, it

must be overhauled or replaced, as indicated in the Dukes Service Bulletin.

**NOTE**

Beech Aircraft Corporation assumes no responsibility for supplying future vendor bulletins or revisions to this vendor service bulletin.

**RECORD COMPLIANCE:** Upon completion of this Service Bulletin, make an appropriate maintenance record entry.

**NOTE**

If you are no longer in possession of this airplane, please forward this information to the present owner.